







MaxDim® Installation Instructions

Parts Included

A		B		Key	Part Name	Included
				A	Solar Panel	1
				B	MaxDim ring	1
				C	Remote Control	1
C		D		D	Battery & Holder	1 (optional extra)

CAUTION

When installing SolarBright® MaxDIM® system ensure that all safety measures and precautions are taken. The installation of the product will require using power tools, climbing on the roof and possibly working in a confined space. The product has been designed to be installed by a handyman, however the installer must be competent to carry out the task safely and correctly. For safe installation and use, do not deviate from these installation instructions.

Required Tools

- Tape Measure
- Gyprock Saw
- Retractable Knife
- Stud Finder
- Impact Driver / Screwdriver
- Drop Sheet / Clean Up Tools
- Tin Snips

Safety Information

- Wear safety glasses and work gloves when using power tools.
- Use protective work gloves while handling tube sections to protect hands from sharp edges.

Step 1

Install MaxLight® Diffuser and bottom tube as per MaxLight® installation instructions.

Step 2

Install Solar Panel as per separate instructions.

Step 3

Fit the MaxDim ring (Flaps facing up) on top of the bottom tube section of your MaxLight. You can secure the MaxDim ring using the foil tape provided. Take note not to put any tape over the 2 holes at the back of the ring.



Step 4

Remove cover from the motor by unscrewing the 4 screws.



SolarBright Australia

11 Progress Circuit, Prestons, NSW 2170
solarbright.com.au | 1300 852 622

© SolarBright Australia | March 2025



Step 5

- Feed cable from Solar Panel into dimmer box via hole at the bottom right hand corner of the box.
- Connect Solar Panel cables into lowest 2 inputs Red cable in the lowest input (S+/DC+), black directly above it (S-/DC-).
- Replace cover once finished.



Step 6 (installing optional battery pack)

- Screw white plastic battery holder to its position on the motor using provided screw - Secure battery to the holder using a cable tie.
- Connect battery cables (without spade connectors) into lowest 2 inputs, red cable in the lowest input, black directly above (as per B in step 5 to the left).
- Connect and secure the supplied 2 spade connectors to cable coming from the Solar Panel.
- Connect battery cables (with spade connectors) to the new spade connectors connected to the cable from Solar Panel (connect matching cable colours).

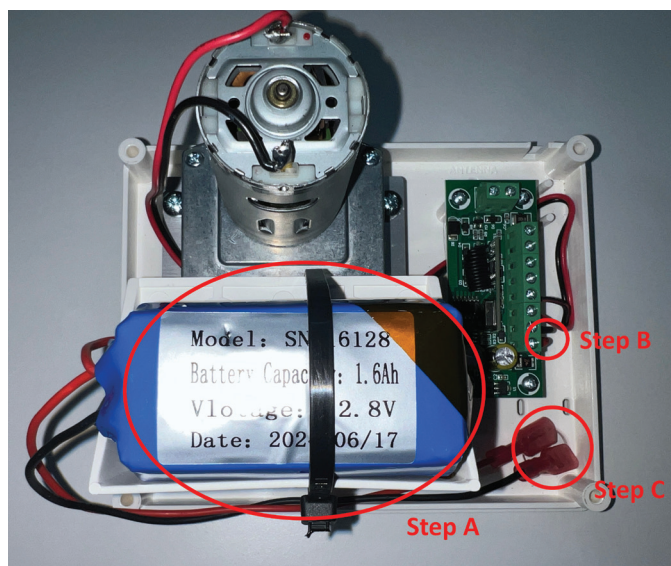

Note

- Install solar powered dimmer in a sunny day to allow the operation of the dimmer and trouble shooting.
- Once Solar Panel is fitted on roof and connected to dimmer, wait for 20 seconds before using the remote control.
- Factory default is designed to use 1 dimmer for 1 skylight using button A
- 1 remote control can be used to operate 3 dimmers using A, B & C buttons (Contact SolarBright for instruction).

Remote Control Pairing Instructions

- Disconnect all power source to the dimmer (Solar and Battery) for 10 seconds.
- Reconnect power supply then push the A and C buttons simultaneously for 5 seconds.
- The two lights above the two buttons will turn solid while the light in the top right hand corner will start flashing. Your Remote Control is ready to use.